



TEMPERATURE CONTROL
FOR TODAY & TOMORROW

MITSUBISHI
HEAVY INDUSTRIES

FDTC35VH1 / SRC35ZS-W2

Capacitate nominala de racire: **3.5 KW**



Poze unitate interna si unitate externa



Specificatii

| | | | |
|--|------------------|----|----------------------------|
| Unitate internă | | | FDTC35VH1 |
| Unitate externă | | | SRC35ZS-W2 |
| Sursă de alimentare | | | Monofazic, 220 - 240, 50Hz |
| Capacitate nominală de răcire (Min~Max) | | kW | 3.5 (0.9 ~ 4.3) |
| Capacitate nominală de încălzire (Min~Max) | | kW | 4.25 (0.9 ~ 4.6) |
| Consum de energie | Răcire/Încălzire | kW | 0.91 / 1.15 |
| EER/COP | Răcire/Încălzire | | 3.85 / 3.70 |



TEMPERATURE CONTROL FOR TODAY & TOMORROW



| | | | |
|--|-------------|--------------------------------------|--|
| Amperaj maxim | | A | 9 |
| Nivel putere sonoră | U.I. | Răcire/Încălzire | 52 / 53 |
| | U.E. | Răcire/Încălzire | 62 / 62 |
| Nivel presiune sonoră | U.I. | Răcire (Hi/Me/Lo/Ulo) | 39 / 36 / 32 / 29 |
| | | Încălzire (Hi/Me/Lo/Ulo) | 41 / 38 / 34 / 30 |
| | U.E. | Răcire/Încălzire | 50 / 50 |
| Flux de aer | U.I. | Răcire (Hi/Me/Lo/Ulo) | 9.0 / 8.0 / 7.5 / 6.5 |
| | | Încălzire (Hi/Me/Lo/Ulo) | 10.0 / 9.0 / 8.0 / 7.0 |
| | U.E. | Răcire/Încălzire | 31.5 / 31.5 |
| Dimensiuni exterioare | U.I. | Înălțime / Lățime / Adâncime | Unit : 248 x 570 x 570 Panou : 10 x 620 x 620 |
| | | | |
| Greutate netă | U.I. / U.E. | | kg 16.0 (Unit : 13.5 Panou : 2.5) / 34.5 |
| Refrigerant | | Tip/GWP | R32/675 |
| Refrigerant | | Încărcare | kg/TCO2Eq 0.78 / 0.527 |
| Dimensiuni țevă refrigerant | | Lichid/Gaz | mm/ø 6.35(1/4") / 9.52(3/8") |
| Lungime țevă refrigerant (o direcție) | | m | Max. 20 |
| Diferență de nivel suportată | | Unitate externă este mai sus/mai jos | m Max. 10 / Max.10 |
| Interval de funcționare - temperatură exterioară | | Răcire | °C -15~46 |

Datorită politicii de continuă îmbunătățire a produselor, ne rezervăm dreptul de a modifica specificațiile tehnice fără nicio notificare prealabilă.



TEMPERATURE CONTROL FOR TODAY & TOMORROW



| | | |
|--|--------|---|
| Încălzire | -15~24 | |
| Panou | | TC-PSA-5AW-E, TC-PSAE-5AW-E (Fagure) / TC-PSAG-5AW-E, TC-PSAGE-5AW-E (Grid) |
| Clasa Energetică (Răcire/Încălzire) | | A++/A++ |
| SEER | | 7.10 |
| SCOP (Climat temperat) | | 4.60 |
| Pdesign (răcire/încălzire(@-10°C)) | kW | 3.50/2.90 |
| Consumul anual de electricitate (răcire/încălzire) | kWh/a | 173/883 |
| Performanța pe modul încălzire | | Climat temperat |

Schema tehnica

Datorită politicii de continuă îmbunătățire a produselor, ne rezervăm dreptul de a modifica specificațiile tehnice fără nicio notificare prealabilă.



TEMPERATURE CONTROL FOR TODAY & TOMORROW



4-way ceiling cassette type (FDTC) FDTC25VH1, 35VH1

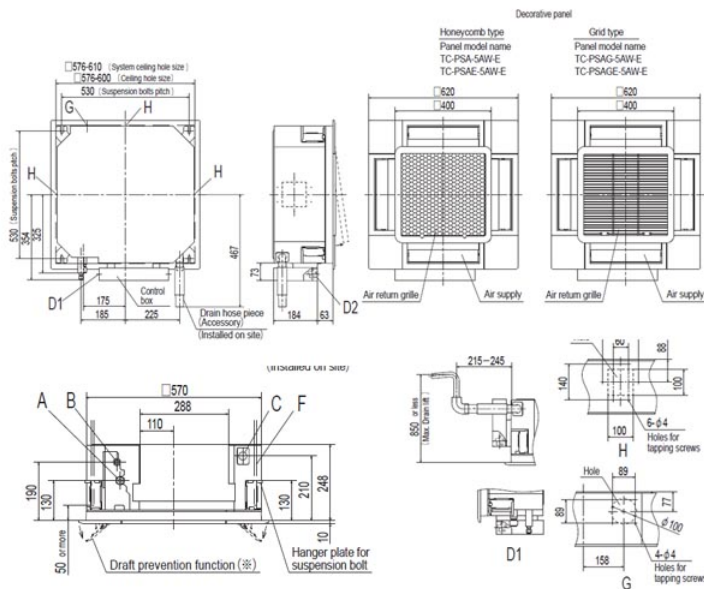

- Notes (1) The model name label is attached to the control box lid.
 (2) This unit is designed for 2×2 grid ceiling.
 If it is installed on a ceiling other than 2×2 grid ceiling, provide an inspection opening on the control box side.
 (3) Draft prevention function (※) is provided on the panel TC-PSA(G)E-5AW-E only.

| Symbol | Content |
|--------|--|
| A | Gas piping φ9.52 (3/8") (Flare) |
| B | Liquid piping φ6.35 (1/4") (Flare) |
| C | Drain piping VP25 (O.D.32) |
| D1 | Power supply connection |
| D2 | Remote control code and signal wiring connection |
| F | Suspension bolts (M10 or M8) |
| G | Outside air opening for ducting (Knock out) |
| H | Air outlet opening for ducting φ125 (Knock out) |
| J | Inspection opening 450×450 |

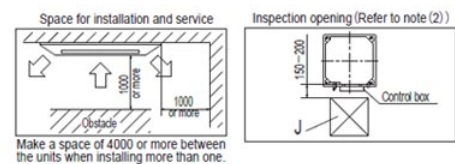

Outdoor units SRC25ZS-W1, W2 SRC35ZS-W1, W2

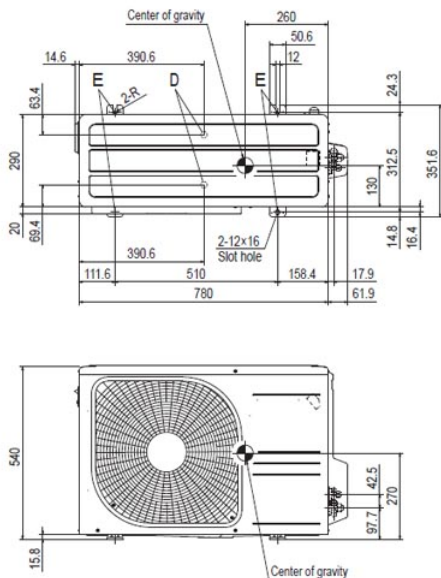

| Installation space | Content |
|--------------------|-------------|
| L1 | 280 or more |
| L2 | 100 or more |
| L3 | 80 or more |
| L4 | 250 or more |

| Symbol | Content |
|--------|--|
| A | Service valve connection (gas side) φ9.52 (3/8") (Flare) |
| B | Service valve connection (liquid side) φ6.35 (1/4") (Flare) |
| C | Pipe/cable draw-out hole |
| D | Drain discharge hole φ20×2 places |
| E | Anchor bolt hole M10-12×4 places |

- Notes (1) The unit must not be surrounded by walls on the four sides.
 (2) The unit must be fixed with anchor bolts. An anchor bolt must not protrude more than 15mm.
 (3) If the unit is installed in the location where there is a possibility of strong winds, place the unit such that the direction of air from the outlet gets perpendicular to the wind direction.
 (4) Leave 200mm or more space above the unit.
 (5) The wall height on the outlet side should be 1200mm or less.
 (6) The model name label is attached on the right side of the unit.

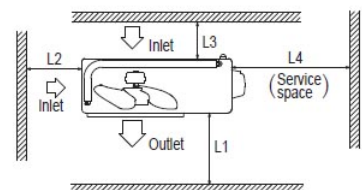
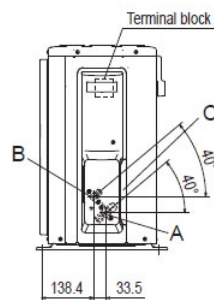

Datorită politicii de continuă îmbunătățire a produselor, ne rezervăm dreptul de a modifica specificațiile tehnice fără nicio notificare prealabilă.